



Tilda®

HAPPY WINTER SNOWMEN QUILT

Tilda®

CLASSIC BASICS

COLLECTION

Happy Winter Snowman Quilt

This quilt is sure to become a classic addition to your décor at Christmas time. Rows of fun snowmen and loving hearts are highlighted against a deep blue winter sky. The quilt is full of interest thanks to the many different colourways used for the blocks. There is also a matching pillow for the quilt – see the Happy Winter Snowman Pillow project.

Where a long eighth or long quarter of a yard is given in the Materials list you could use fat eighths and fat quarters instead. A fat eighth is assumed to be approximately 10½in x 18in (26.7cm x 45.7cm) and a fat quarter approximately 21in x 18in (53.3cm x 45.7cm).

Materials

- Fabric 1: ¼yd (25cm) – Pen Stripe pink (130031)
- Fabric 2: ⅛yd (15cm) – Pen Stripe light blue (130032)
- Fabric 3: ¼yd (25cm) – Pen Stripe grey (130033)
- Fabric 4: ¼yd (25cm) – Paint Dots pink (130034)
- Fabric 5: ¼yd (25cm) – Paint Dots light blue (130035)
- Fabric 6: ¼yd (25cm) – Paint Dots grey (130036)
- Fabric 7: ¼yd (25cm) – Tiny Star pink (130037)
- Fabric 8: ⅛yd (15cm) – Tiny Star light blue (130038)
- Fabric 9: ¼yd (25cm) – Tiny Star grey (130039)
- Fabric 10: ¼yd (25cm) – Crisscross pink (130040)
- Fabric 11: ¼yd (25cm) – Crisscross light blue (130041)
- Fabric 12: ¼yd (25cm) – Crisscross grey (130042)
- Fabric 13: ¼yd (25cm) – Dotty Dots pink (130043)
- Fabric 14: ¼yd (25cm) – Dotty Dots light blue (130044)
- Fabric 15: ½yd (50cm) – Dotty Dots grey (130045)
- Fabric 16: ⅛yd (15cm) – Tiny Dots pink (130046)
- Fabric 17: ¼yd (25cm) – Tiny Dots light blue (130047)
- Fabric 18: ¼yd (25cm) – Tiny Dots grey (130048)
- Fabric 19: 2¾yd (2.5m) – Solid lupine (120013)
- Backing fabric 3½yd (3.2m)
- Wadding (batting) 61in x 79½in (155cm x 202cm)
- Binding fabric ½yd (50cm) – Pen Stripe pink (130031)
- Two packets of Tilda buttons ½in (15mm) diameter (400010) – 18 buttons
- Three packets of Tilda buttons ¾in (20mm) diameter (400011) – 18 buttons
- Black stranded embroidery cotton (floss) for embroidering eyes
- Removable fabric marker
- Piecing and quilting threads
- Quilter's ruler, rotary cutter and mat

Finished Size

52½in x 71in (133.3cm x 180.3cm)

Notes

- Fabric quantities given are based on a usable width of 42in (107cm)
- Measurements are in imperial inches with metric conversions in brackets – use only *one* system throughout (preferably imperial)

- Wash all fabrics before use and press before cutting
- Use ¼in (6mm) seams unless otherwise instructed
- Read all the instructions through before you start

Preparation and Cutting Out

1 This quilt is made up of three different blocks: a small snowman block in five different colourways, a large snowman block in a single colourway and a heart block in six different colourways. Plain horizontal sashing strips separate the quilt rows, with a pieced squares row at the top and bottom of the quilt. The fabrics used are shown in **Fig A** and the quilt layout in **Fig B**.

2 For the solid Fabric 19 long horizontal sashing strips cut these first from the *length* of the fabric, to avoid joins. Cut six strips 2in x 53in (5.1cm x 134.6cm). (You could cut the strips a little longer in case your quilt measurements differ from ours.)

3 For the solid Fabric 19 short vertical sashing strips between the heart blocks, cut from the remaining width of fabric, cutting ten strips 1¾in x 7in (3.5cm x 17.8cm).

4 All of the blocks use the solid Fabric 19 as a background, so there are many pieces to cut. To make things easier, you could cut these now, putting them in labelled piles. (Alternatively, you could cut them later – the pieces and their sizes are given in **Fig C**, **Fig J** and **Fig L**.) Most of the shapes are squares, so cut the fabric in strips across the width and then sub-cut into the sizes needed. The total numbers to cut for the whole quilt are given here.

- For the small snowmen – piece **a** – 8in x 2½in (20.3cm x 6.4cm). Cut 20.
- For all snowmen – piece **b** – 3in (7.6cm) square. Cut 28.
- For all snowmen – piece **d** – 1¼in (3.2cm) square. Cut 56.
- For all snowmen – piece **h** – 3in (7.6cm) square. Cut 28.
- For the small snowmen – piece **k** – 2in x 2½in (5.1cm x 6.4cm). Cut 40.
- For the large snowmen – piece **k** – 2in x 3in (5.1cm x 7.6cm). Cut 16.
- For all snowmen – piece **m** – 1¼in (3.2cm) square. Cut 56.
- For all snowmen – piece **o** – 2in (5.1cm) square. Cut 112.
- For the hearts – piece **b** – 1½in (3.8cm) square. Cut 24.
- For the hearts – piece **c** – 2in (5.1cm) square. Cut 24.
- For the hearts – piece **d** – 4½in (11.4cm) square. Cut 24.
- For the pieced squares rows – 2in (5.1cm) squares. Cut 34.

5 For the print fabrics, the exact measurements for cutting out the three different blocks are given with the block instructions and relevant diagrams. You might find it best to cut the fabrics and make the blocks one at a time, to avoid confusing all the pieces.

6 Cut the backing fabric in half across the width. Sew the pieces together along the long side. Press the seam open and trim to a piece about 61in x 79½in (155cm x 202cm).

7 From the binding fabric cut seven strips 2½in (6.4cm) x width of fabric. Sew together end to end and press the seams open. Press in half along the length, wrong sides together.

Fig A Fabric swatches

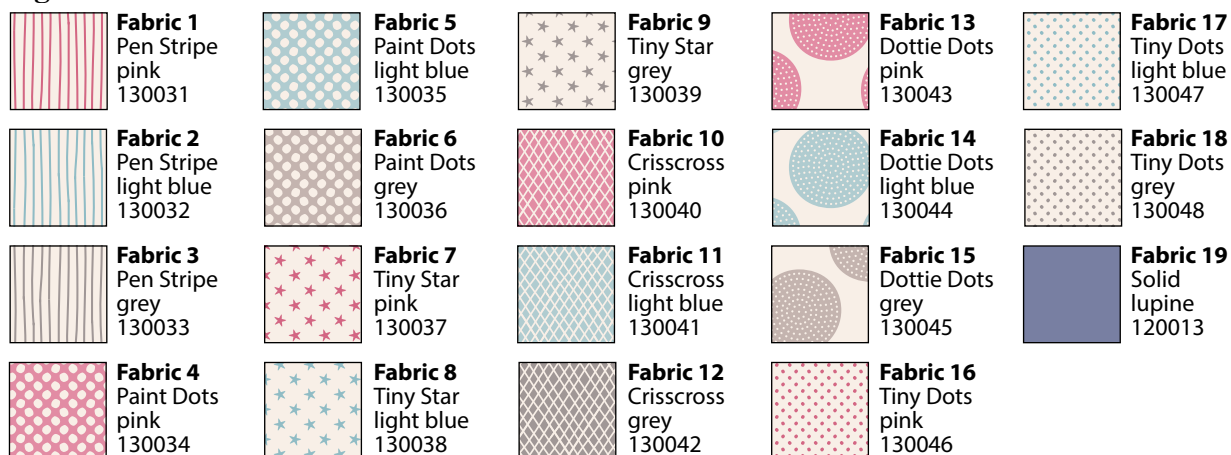

Fig B Quilt layout



Small Snowman Block

8 A small snowman block is made up of three sections – the top (sky), the head and the body. Each block is made the same way, but in five different colourways (Blocks A, B, C, D and E). Small snowman block A is described and illustrated in detail. **Fig C** shows the layout of the block, with the letters indicating the cut sizes of the fabric pieces. Cut out the pieces needed for one block, following exactly the measurements on the diagram. Seam allowances are included. (You may have already cut all the Fabric 19 blue solid pieces.) You might find it best to cut the pieces for each block as you make it. **Fig D** shows the different colourways for the blocks, so change fabrics depending on the colourway you are making.

Fig C Small snowman block layout and cutting

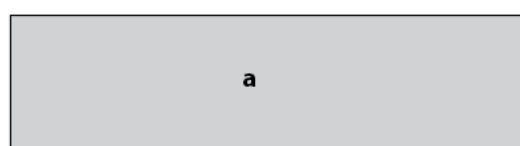

Small snowman top (sky)

a 8in x 2½in (20.3cm x 6.4cm).

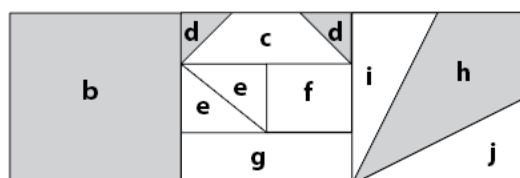

Small snowman head

b 3in (7.6cm) square.

c 3in x 1¼in (7.6cm x 3.2cm).

d 1¼in (3.2cm) square.

e 1¾in x 1½in (4.4cm x 3.8cm).

f 1¾in x 1½in (4.4cm x 3.8cm).

g 3in x 1¼in (7.6cm x 3.2cm).

h 3in (7.6cm) square.

i 1¾in x 3in (4.4cm x 7.6cm).

j 3in x 1¾in (7.6cm x 4.4cm).

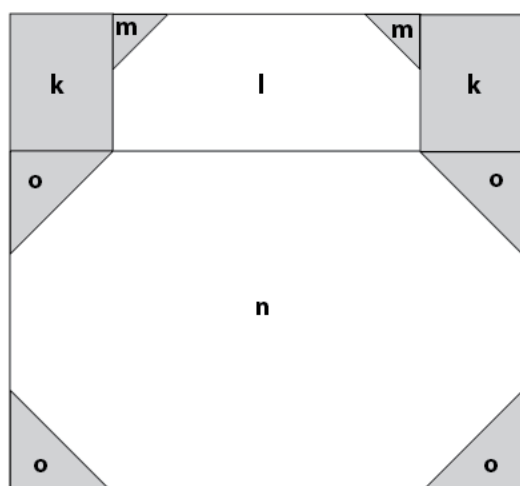

Small snowman body

k 2in x 2½in (5.1cm x 6.4cm).

l 5in x 2½in (12.7cm x 6.4cm).

m 1¼in (3.2cm) square.

n 8in x 5½in (20.3cm x 14cm).

o 2in (5.1cm) square.

Fig D Small snowman block colourways
Numbers indicate fabrics used. Make 4 of each block

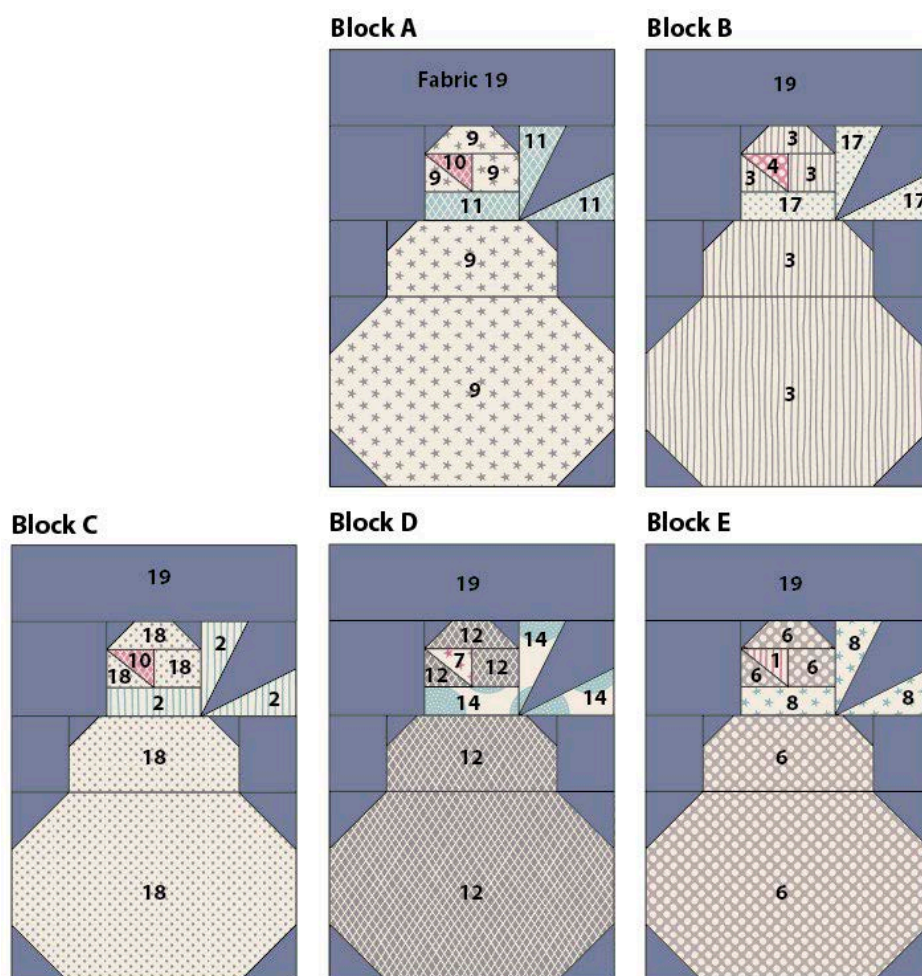

Making a Small Snowman (Block A)

9 The top (sky): This section is just a single piece of Fabric 19, cut 8in x 2½in (20.3cm x 6.4cm).

10 Small snowman head: For this section you need the following pieces (see measurements in Fig C). Block A fabrics are described here.

- b** – one piece of Fabric 19.
- c** – one piece of Fabric 9.
- d** – two pieces of Fabric 19.
- e** – one piece of Fabric 9 and one piece of Fabric 10.
- f** – one piece of Fabric 9.
- g** – one piece of Fabric 11.
- h** – one piece of Fabric 19.
- i** – one piece of Fabric 11.
- j** – one piece of Fabric 11.

11 Small snowman body: For this section you need the following pieces (see measurements in Fig C).

- k** – two pieces of Fabric 19.
- l** – one piece of Fabric 9.

m – two pieces of Fabric 19.

n – one piece of Fabric 9.

o – four pieces of Fabric 19.

12 To make the head section: For the top of the head take a **c** piece of Fabric 9 and two **d** pieces of Fabric 19. Place the squares right sides together with the rectangle, aligning the outer edges as shown in **Fig E**. Sew along each diagonal as shown. Trim excess fabric $\frac{1}{4}$ in (6mm) away from the sewn lines. Press the corner triangles outwards, pressing the seam open or towards the darker fabric.

Fig E Making the top of the head

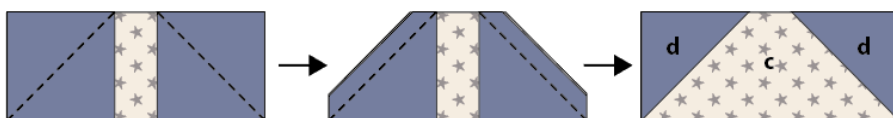

13 For the nose, take an **e** piece of Fabric 9 and using an erasable marker, mark the $\frac{1}{4}$ in (6mm) seam allowance on the *right* side of the fabric (**Fig F1**). Take an **e** piece of Fabric 10 and mark the $\frac{1}{4}$ in (6mm) seam allowance on the *wrong* side of the fabric. On Fabric 10, draw a diagonal line from corner to corner of the inner shape, in the direction shown on the diagram. Place the fabrics right sides together as in **Fig F2**, carefully angling the pink rectangle so the ends of the diagonal line are matched with the seam allowance corners of the fabric below. Pin in place and then sew along the marked diagonal line (you can sew past the ends of the line if you want). Trim excess fabric $\frac{1}{4}$ in (6mm) above the sewn line (**Fig F3**). Remove the markings and then press the seam open or towards the darker fabric (**Fig F4**). Check the unit is $1\frac{3}{4}$ in x $1\frac{1}{2}$ in (4.4cm x 3.8cm).

Fig F Making the nose

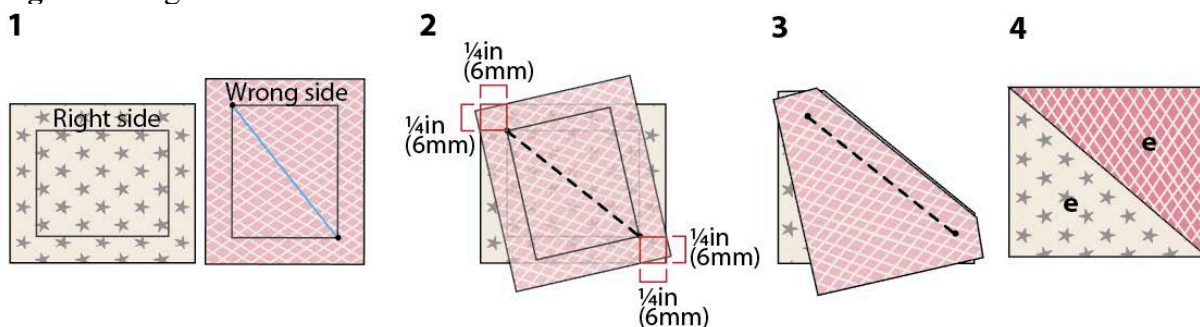

14 For the scarf, the angled piecing is created in a similar way to the nose. Take an **h** piece of Fabric 19 and mark the $\frac{1}{4}$ in (6mm) seam allowance on the *right* side of the fabric (**Fig G1**). Along the top edge of the square, mark a point on the marked seam allowance $1\frac{1}{2}$ in (3.8cm) in from the raw left-hand edge of the square, as shown. Do the same on the right-hand side of the square. Take the **i** and **j** pieces of Fabric 11 and mark the $\frac{1}{4}$ in (6mm) seam allowance on the *wrong* sides. On one of the rectangles draw a diagonal line from corner to corner of the inner shape, as shown in **Fig G1**. On the other rectangle draw the line the opposite way.

15 Place the **i** rectangle right sides together with the square, carefully aligning the lower left seam allowance points. At the top, align the end of the marked diagonal line with the $1\frac{1}{2}$ in (3.8cm) mark, as shown in **Fig G2**. Pin in place and then sew along the marked diagonal line. Trim excess fabric $\frac{1}{4}$ in (6mm) away from the sewn line (**Fig G3**). Press the triangle

outwards. Repeat this process with the other rectangle, this time angling it as shown in **Fig G4**. Pin, sew and trim excess fabric as before, and then press (**Fig G5**). Remove the markings and check the unit is 3in (7.6cm) square.

Fig G Making the scarf

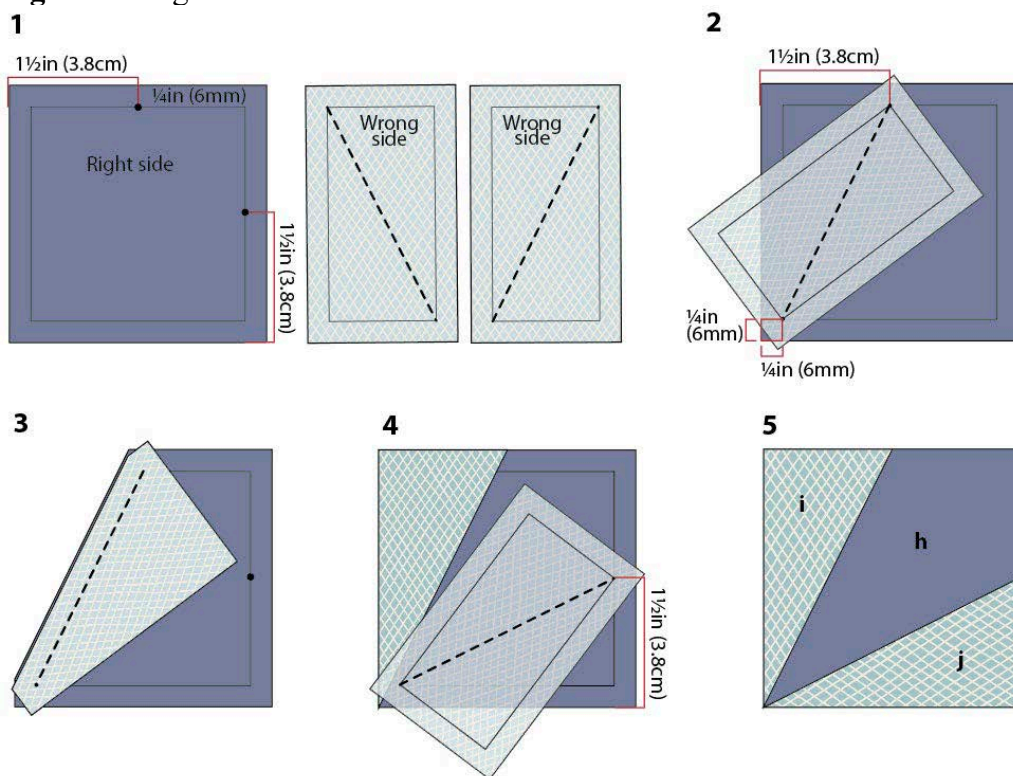

16 To make the body section: For the top part of the body (see **Fig H1**), add the two **m** squares to the **l** rectangle to create corner triangles in the same way that you did for the top of the head. Now sew a piece **k** to each side of this pieced unit. For the bottom part of the body add the four **o** squares to the **n** rectangle to create corner triangles in the same way as before (**Fig H2**). Now sew the top part of the body to the bottom part (**Fig H3**) and press.

Fig H Making the body

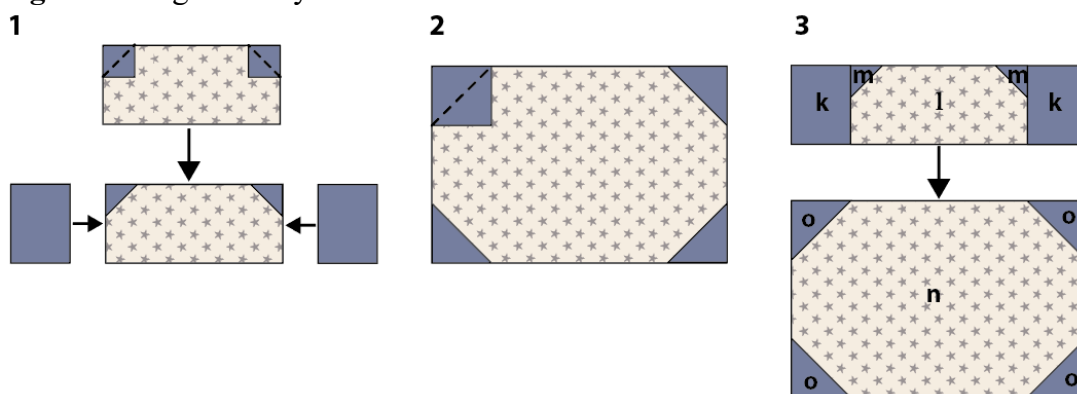

17 To assemble a small snowman block, follow the sequence in **Fig I**, sewing the units of the head section together first and then adding the top section and body section. Check the unfinished block is 8in x 12in (20.3cm x 30.5cm).

Fig I Assembling the small snowman block

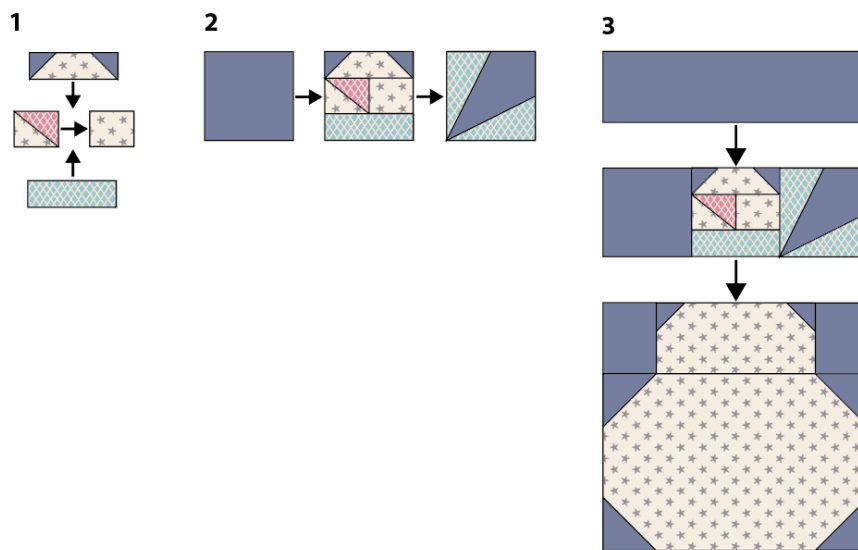

18 Repeat the sewing and assembly process to make twenty small snowmen blocks in total – four each of Block A, Block B, Block C, Block D and Block E (see Fig D for the colourways).

19 You can embroider the eye on each snowman after each block is made, or later when assembling the quilt if you prefer. Use all six strands of black embroidery cotton (floss) and French knots, winding the thread around the needle twice. See **Fig B** for the eye positions.

Large Snowman Block

20 The large snowman is made in a single colourway (Block F) and doesn't have a top (sky) piece. Note that the head section is cut using the *same* sizes as the small snowman but in different fabrics. Follow **Fig J** for the cutting measurements and **Fig K** for the fabrics used. (You may have already cut the solid Fabric 19 pieces.)

21 Large snowman head: For this section you need the following pieces.

- b** – one piece of Fabric 19.
- c** – one piece of Fabric 15.
- d** – two pieces of Fabric 19.
- e** – one piece of Fabric 15 and one piece of Fabric 4.
- f** – one piece of Fabric 15.
- g** – one piece of Fabric 5.
- h** – one piece of Fabric 19.
- i** – one piece of Fabric 5.
- j** – one piece of Fabric 5.

22 Large snowman body: For this section you need the following pieces. Note that the measurements are different to the small snowman – see **Fig J**.

- k** – two pieces of Fabric 19.
- l** – one piece of Fabric 15.
- m** – two pieces of Fabric 19.
- n** – one piece of Fabric 15.
- o** – four pieces of Fabric 19.

Fig J Large snowman block layout and cutting

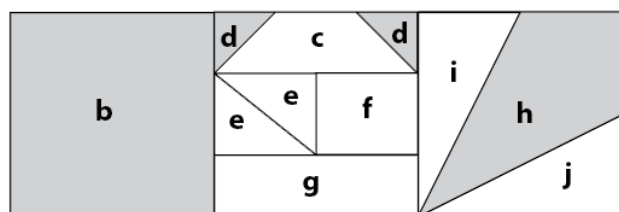

Large snowman head

Cut and sew the same as the small snowman head.

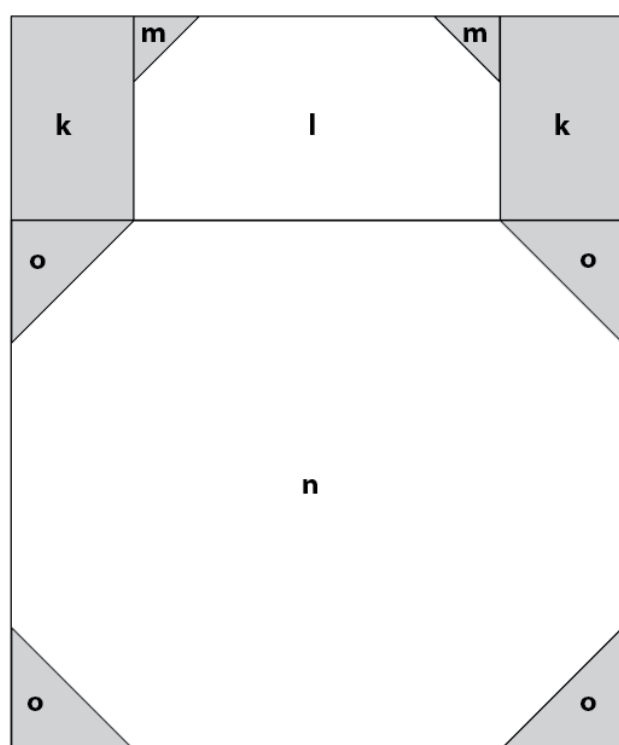

Large snowman body

k 2in x 3in (5.1cm x 7.6cm).

l 5in x 3in (12.7cm x 7.6cm).

m 1¼in (3.2cm) square.

n 8in x 7in (20.3cm x 17.8cm).

o 2in (5.1cm) square.

Fig K Large Snowman block colourway
Numbers indicate fabrics used. Make 8 blocks

Block F

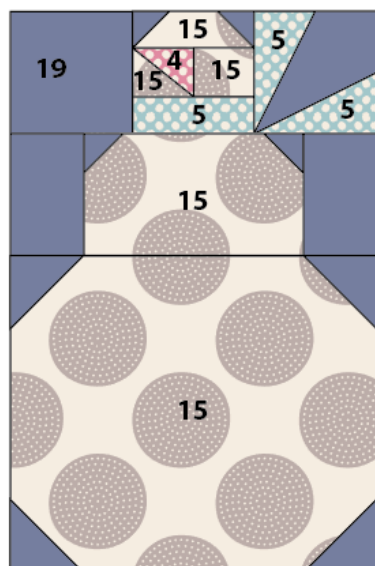

Making a Large Snowman (Block F)

23 Make the large snowman head section in the same way as the small snowman (see **Figs E, F and G**). Make the large snowman body section in the same way as the small snowman but using the larger pieces of fabric.

24 Assemble the large snowman in the same way as the small snowman but without the top sky piece. Check the unfinished block is 8in x 12in (20.3cm x 30.5cm). Repeat the process to make eight blocks in total.

Heart Block

25 Each heart block is made the same way, but in six different colourways (Blocks G, H, I, J, K and L). Heart block G is described and illustrated in detail. **Fig L** shows the layout of the block, with the letters indicating the cut sizes of the fabric pieces. **Fig M** shows the different colourways for the blocks, so change fabrics depending on the block you are making.

26 For a heart block you need the following pieces (see measurements in **Fig L**). Block G fabrics are described here. (You may have already cut the solid Fabric 19 pieces.)

a – two pieces of Fabric 1 (change this fabric depending on the block you are making).

b – two pieces of Fabric 19.

c – two pieces of Fabric 19.

d – two pieces of Fabric 19.

Fig L Heart block layout and cutting

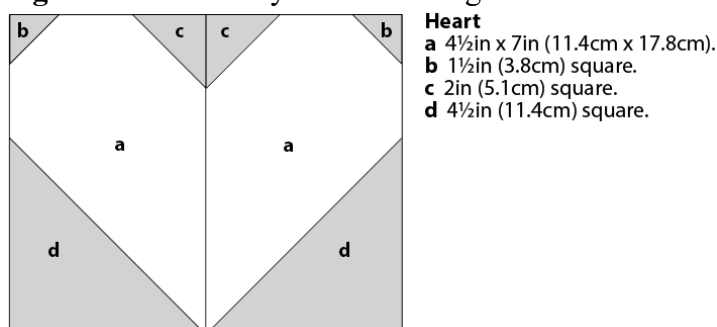
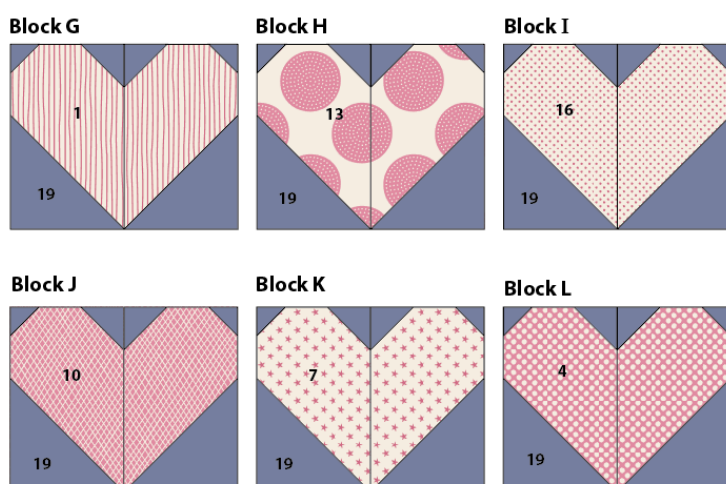

Fig M Heart block colourways

Numbers indicate the fabrics used. Make 2 of each block.



27 To Make a heart block, place the print rectangle (**a**) right side up and arrange the **b**, **c** and **d** solid squares as shown in **Fig N1**. Sew across the diagonals of the squares, as you did before to create triangle corners. Repeat this for the other side of the block, reversing the positions of the solid squares, as shown. Trim excess fabric $\frac{1}{4}$ in (6mm) away from each sewn line and then press the triangles outwards. Now sew the two halves of the block together (**Fig N2**) and press the seam. Check the unfinished block is $8\frac{1}{2}$ in x 7in (21.6cm x 17.8cm). Repeat this process to make two of each block colourway.

Fig N Sewing a heart

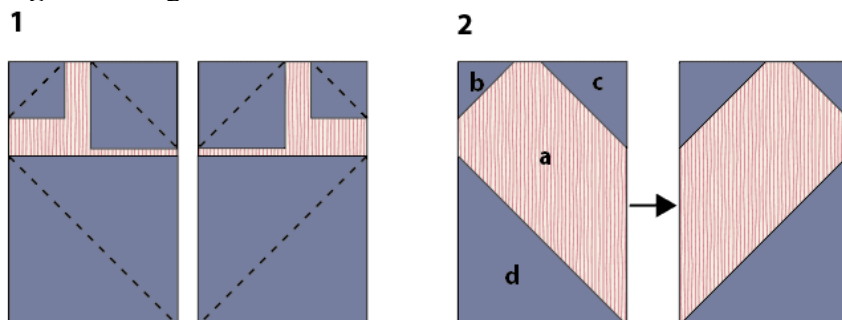

Pieced Square Rows

28 These rows are at the top and bottom of the quilt. Cut the following 2in (5.1cm) squares (this will make both rows).

- Fabric 2 – six squares.
- Fabric 5 – six squares.
- Fabric 8 – six squares.
- Fabric 11 – six squares.
- Fabric 14 – six squares.
- Fabric 17 – six squares.
- Fabric 19 – thirty-four squares (you may have already cut these).

29 Arrange the squares in sections as shown in **Fig O**. Note that there are two sections – they are identical except that Section 1 has an extra Fabric 19 square at the end. Sew the squares together using $\frac{1}{4}$ in (6mm) seams and press the seams open or to one side. Repeat to make a total of four of Section 1 and two of Section 2.

30 Arrange two of Section 1 and one of Section 2 as shown in **Fig P** and then sew them together. This is the top row of the quilt. Repeat the sewing to make the bottom row.

Fig O Making the pieced square rows
Numbers indicate fabrics used

Section 1 – make 4



Section 2 – make 2



Fig P Assembling the top row

Repeat the assembly for the bottom row of the quilt and then rotate it 180 degrees

Assembling the Quilt

31 Follow **Fig B** carefully, laying out the heart blocks as shown. Place a vertical sashing piece between each of the hearts. Sew all the units together using a *scant* $\frac{1}{4}$ in (6mm). A scant seam is needed to ensure that the sewn row measures 53in (134.6cm) long. Press the seams.

32 Follow **Fig B** carefully to lay out the snowmen blocks in the order shown on the diagram. Sew each of the four rows together using normal $\frac{1}{4}$ in (6mm) seams, and then press the seams.

33 Lay out all of the rows of the quilt as in **Fig B**. Note that there is a long horizontal sashing strip between all of the rows of the quilt, *except* under the top heart row. Arrange the bottom pieced square row so it is rotated 180 degrees. Sew all the rows together and press the seams.

Quilting and Finishing

34 If you are quilting the quilt yourself you now need to make a quilt sandwich – you can do this in various ways, as follows.

- Use large stitches to tack a grid through the layers of the quilt in both directions, with lines about 4in (10cm) apart.
- Use pins or safety pins to fix the layers together.
- Use fabric glue, sprayed onto the wadding to fix the layers together.

If you are sending the quilt off to be commercially long-arm quilted you won't need to make a sandwich, as this is done when the quilt is mounted on the machine. When the layers of the quilt are secured you can quilt as desired.

35 Using matching sewing thread, sew the buttons onto the snowmen. Note that some snowmen have one button and others have two. We distributed half the buttons (one packet of small buttons and one and a half packets of large buttons) on the first two snowman rows, and then repeated this placement on the two lower rows. See **Fig B** for the positions. You could, of course, position the buttons as you choose.

36 Use the prepared double-fold binding strip to bind your quilt. Sew the binding to the quilt by pinning the raw edge of the folded binding against the raw edge of the quilt. Don't start at a corner. Using a $\frac{1}{4}$ in (6mm) seam, sew the binding in place, starting at least 6in (15.2cm) away from the end of the binding. Sew to within a $\frac{1}{4}$ in (6mm) of a corner and stop. Take the quilt off the machine and fold the binding upwards, creating a mitred corner. Hold this in place, fold the binding back down and pin it in place. Begin sewing the $\frac{1}{4}$ in (6mm) seam again from the top of the folded binding to within $\frac{1}{4}$ in (6mm) of the next corner and then repeat the folding process. Do this on all corners. Leave a 6in (15.2cm) 'tail' of unsewn binding at the end.

37 To join the two ends of the binding, open up the beginning and end of the binding tails, lay them flat and fold the ends back so the two ends touch. Mark these folds by creasing or with pins – this is where your seam needs to be. Open out the binding and sew the pieces

together at these creases. Trim off excess fabric and press the seam. Re-fold the binding and finish stitching it in place on the front of the quilt.

38 With the quilt right side up, use a medium-hot iron to press the binding outwards all round. Now begin to turn the binding over to the back of the quilt, pinning it in place. Use matching sewing thread and tiny stitches to slipstitch the binding in place all round, creating neat mitres at each corner. Press the binding and your lovely quilt is finished.