

Benartex **KANVAS**

FOR THE LOVE OF COFFEE BY NICOLE DECAMP









But First Coffee (6) Placemats

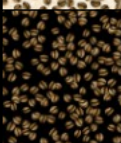

Free pattern designed by Stephanie Sheridan • Finished Size: 14" X 18"

CUTTING INSTRUCTIONS

*WOF = Width of fabric | *Sew strips via short ends, then subcut as indicated in pattern*

	COFFEE TIME PANEL 14153-71 <i>Neutral</i>	1 Panel	<i>Fussy Cut:</i> (6) 10" squares		COFFEE MEDALLION 14159-77 <i>Espresso</i>	1/2 YD	(6) 2-1/4" X WOF strips, BINDING
	COFFEE & PASTRIES 14157-72 <i>Caramel</i>	1/4 YD	<i>Fussy Cut:</i> (3) 3-1/2" X 10" rectangles		LITTLE COFFEE BEANS 14160-07 <i>Cream</i>	1/2 YD	(5) 1-1/2" X WOF strips *, BORDER
	ITS COFFEE TIME 14158-12 <i>Black</i>	1 FQ	<i>Fussy Cut:</i> (3) 3-1/2" X 10" rectangles		LITTLE COFFEE BEANS 14160-12 <i>Black</i>	1/2 YD	(5) 1-1/2" X WOF strips *, BORDER
	COFFEE MEDALLION 14159-73 <i>Toast</i>	1/3 YD	(5) 1-1/2" X WOF strips, subcut (6) 1-1/2" X 14" strips, (6) 1-1/2" X 12" strips, and (3) 1-1/2" X 10" strips		COFFEE GEO 14161-73 <i>Toast</i>	1/2 YD	(6) 2-1/4" X WOF strips, BINDING
					COFFEE GEO 14161-77 <i>Espresso</i>	1/3 YD	(5) 1-1/2" X WOF strips, subcut (6) 1-1/2" X 14" strips, (6) 1-1/2" X 12" strips, and (3) 1-1/2" X 10" strips

PLACEMAT A ASSEMBLY: Refer to **DIAGRAM** for proper placement and rotation.

- Sew together (1) **A** 10" square, (1) **D** 1-1/2" X 10" strip, and (1) **C** 3-1/2" X 10" rectangle to create **PLACEMAT CENTER A**. Square to 10" X 14", make (3).

BORDER ASSEMBLY: Measure width and length of quilt top to ensure border cutting sizes. Below are our measurements.

- Sew (1) **D** 1-1/2" X 14" strip to top and bottom of **PLACEMAT CENTER A**, then sew (1) **D** 1-1/2" X 12" strip to each side.
- Sew (1) **G** 1-1/2" X (16") strip to top and bottom, then sew (1) **G** 1-1/2" X (14") strip to each side.

FINISHING:

Cut batting and backing 3" larger than top on all sides. Layer backing, batting and top together and baste or pin. When quilting is completed, trim excess batting and backing. Bind with **H** fabric.

DIAGRAMS

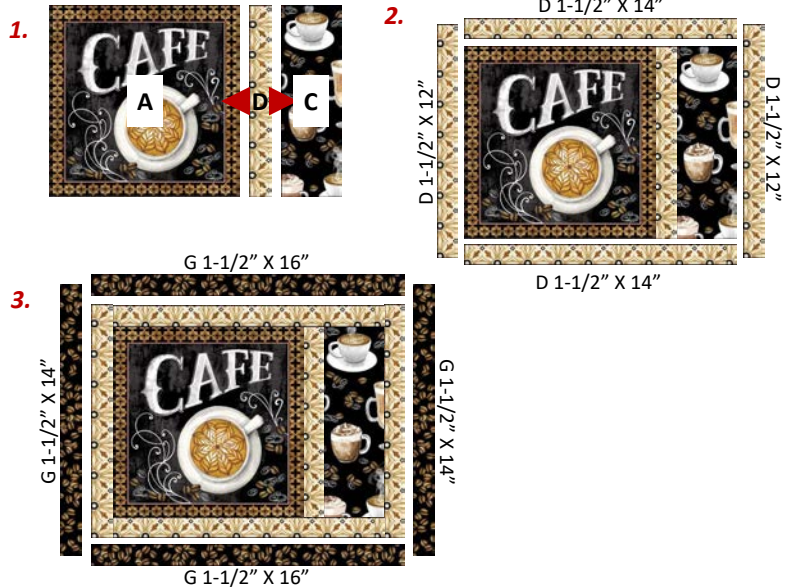

PLACEMAT A make (3)



PLACEMAT B make (3)



PLACEMAT B:

Repeat all steps using the following fabrics, make (3).

CENTER: **A - J - B**

BORDER 1: **J**

BORDER 2: **F**

Bind with fabric **E**.