

woodland gardens featuring *garden party* by kathy tanis

Kathy Tanis' debut collection, Garden Party, is a hand-painted watercolor motif where woodland creatures come out to play. Deers, bears, bunnies and raccoons live among forest blossoms, wild diamonds and pretty ikat prints in coral, sky blue, pink, purple and navy. The unique artistry in the collection is a feast for the eyes. See the entire Garden Party Collection on our website: www.blendfabrics.com



Quilt Design by Carol Dockery of Quilter by Night Designs

blend
fabrics llc

99 armour dr ne • atlanta, ga 30324 • 855.817.0604 • 404.817.0604 • www.blendfabrics.com

garden party

by kathy tanis

Finished Quilt Size: 52-1/2" x 60-1/2"

Be sure to read through instructions before beginning. Cutting instructions include 1/4" seam allowance. Yardage is based on 42" of usable fabric width. All strips are cut across the width of fabric (WOF) unless otherwise stated. Press the seam allowance in the direction of the arrows as you assemble the blocks.

Fabric Requirements & Cutting Instructions:

Garden Party Friends White 124.101.01.1 3/4 yard

Cut (4) 12-1/2" squares

Garden Party Friends Navy 124.101.01.2 3/4 yard

Cut (5) 12-1/2" squares

Painted Ikat Coral 124.101.02.1 5/8 yard

Cut (2) 4-1/2" x WOF strips. Subcut into (16) 4-1/2" squares

Cut (2) 4-7/8" x WOF strips. Subcut (1) strip into (9) 4-7/8" squares. Subcut (1) strip into (1) 4-7/8" square and (1) 4-1/2" square.

Painted Ikat Green 124.101.02.2 1/3 yard

Cut (10) 4-7/8" squares

Forest Blossoms Blue 124.101.03.1 1/4 yard

Cut (4) 4-1/2" squares

Forest Blossoms Purple 124.101.03.2 1/4 yard

Cut (4) 4-1/2" squares

Petite Raccoon Pink 124.101.04.1 1/4 yard

Cut (2) 4-1/2" squares

Petite Raccoon Blue 124.101.04.2 1/4 yard

Cut (4) 4-1/2" squares

Woodland Floral Ivory 124.101.05.1 1/4 yard

Cut (4) 4-7/8" squares

Cut (4) 4-1/2" squares

Woodland Floral Pink 124.101.05.2 1/2 yard

Cut (8) 4-7/8" squares

Cut (8) 4-1/2" squares

Wild Diamonds Pink 124.101.06.1 3/4 yard

Cut (10) 4-7/8" squares

Cut (30) 4-1/2" squares

Wild Diamonds Blue 124.101.06.2 3/4 yard

Cut (10) 4-7/8" squares

Cut (30) 4-1/2" squares

Binding - Painted Ikat Green 124.101.02.2 1/2 yard

Backing - Any Garden Party Print 3-1/2 yards

Block Assembly:

1. Lay a 4-7/8" square (Wild Diamond Pink), right sides together, on a 4-7/8" square (Painted Ikat Green) aligning the edges. Draw a diagonal line from corner to corner on the wrong sides of the top square.

Sew 1/4" on each side of the line. Cut along the line to create 2 half-square triangle units. Press the seam allowance toward the darker color. Each unit should measure 4-1/2" square. Repeat to make a total of 20 (Wild Diamond Pink/Painted Ikat Green) half-square triangle units.

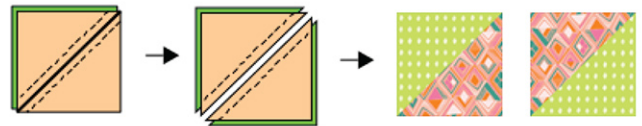

2. Using 2 of the above half-square triangle units and a 4-1/2" square of Wild Diamonds Pink square, make a Unit 1 as shown.

Repeat to make a total of 10 Unit 1.

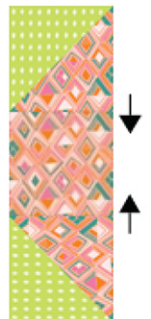

Unit 1-Make 10

3. Repeat step 1 using a 4-7/8" (Painted Ikat Coral) square and a 4-7/8" (Wild Diamond Blue) square to make a (Painted Ikat Coral/Wild Diamond Blue) half-square triangle unit.

Repeat to make a total of 20 units. Combine these half-square triangle units with the 4-1/2" (Wild Diamond Blue) squares to make 10 Unit 2 as shown.

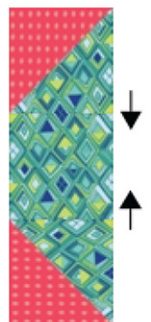

Unit 2-Make 10

4. Lay a 4-1/2" (Wild Diamond Pink) square, right sides together, in the upper left corner of a 12-1/2" (Garden Party Friends Navy) square, aligning the edges. Draw a diagonal line from corner to corner on the wrong sides on the smaller square as shown.

Sew on the line. Trim the seam allowance to 1/4". Press the seam allowance toward the added triangle.

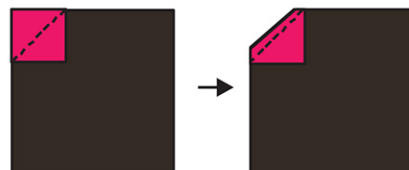

blend

fabrics llc

99 armour dr ne
atlanta, ga 30324

855.817.0604

404.817.0604

www.blendfabrics.com

Block Assembly Continued:

Referring to the Block A and Block A (reversed) diagrams for placement, repeat in the remaining 3 corners using a 4-1/2" (Wild Diamond Pink) square and (2) 4-1/2" (Painted Ikat Coral) squares to complete Block A. The block should measure 12-1/2" square. Repeat to make another Block A and (2) Block A (reversed) as shown below.



Block A-Make 2



Block A (r)-Make 2

5. Repeat Step 4 using a 12-1/2" (Garden Friends Ivory) square, 2 (Wild Diamond Pink) squares and 2 (Painted Ikat Coral) squares to make Block B. Repeat to make a second Block B and (2) Block B (reversed) as shown.



Block B-Make 2



Block B (r)-Make 2

6. Repeat Step 4 using a 12-1/2" (Garden Party Friends Navy) square and (4) 4-1/2" (Wild Diamond Blue) squares to make Block C.



Block C-Make 1

7. Repeat Step 1 using (2) 4-7/8" (Wild Diamond Pink) squares and (2) 4-7/8" (Woodland Floral Pink) squares to make a total of 4 half-square triangle units. Repeat Step 1 again using (2) 4-7/8" (Painted Ikat Coral) squares and (2) 4-7/8" (Woodland Floral Pink) squares to make a total of 4 half-square triangle units.



Make 4

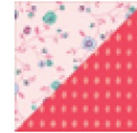

Make 4

8. Using the half-square triangles made in Step 7, (4) 4-1/2" (Woodland Floral Pink) squares and (1) 4-1/2" (Petite Raccoon Blue) square, assemble Block D as shown. Repeat to make a Block D reversed.



Block D-Make 1



Block D (r)-Make 1

9. Repeat Step 1 using (4) 4-7/8" (Wild Diamond Blue) squares and (4) 4-7/8" (Woodland Floral Pink) squares to make a total of 8 half-square triangle units. Using 2 of these units, (2) 4-1/2" (Forest Blossoms Purple) and (1) 4-1/2" (Petite Raccoon Blue) square, assemble Block E as shown. Repeat to make a second Block E.



Block E-Make 2

10. Repeat Step 1 using (4) 4-7/8" (Wild Diamond Blue) squares and (4) 4-7/8" (Woodland Floral Ivory) squares to make a total of 8 half-square triangle units. Using 2 of these units, (2) 4-1/2" (Forest Blossoms Blue) and (1) 4-1/2" (Petite Raccoon Pink) square, assemble Block F as shown. Repeat to make a second Block F.



Block F-Make 2

Quilt Top Assembly:

1. Referring to the Quilt Diagram, lay out Units 1 and 2 and Blocks A through F as shown. Note that Unit 1 and Unit 2 may need to be rotated 180 degrees in the lay out.
2. Sew each row of blocks together, pressing the seam allowances in rows 1, 3, and 5 to the right and the seam allowances in rows 2 and 4 to the left.
3. Sew the rows together. Press the seam allowance in any direction.
4. The completed quilt top should measure 52-1/2" x 60-1/2"

Quilt Diagram

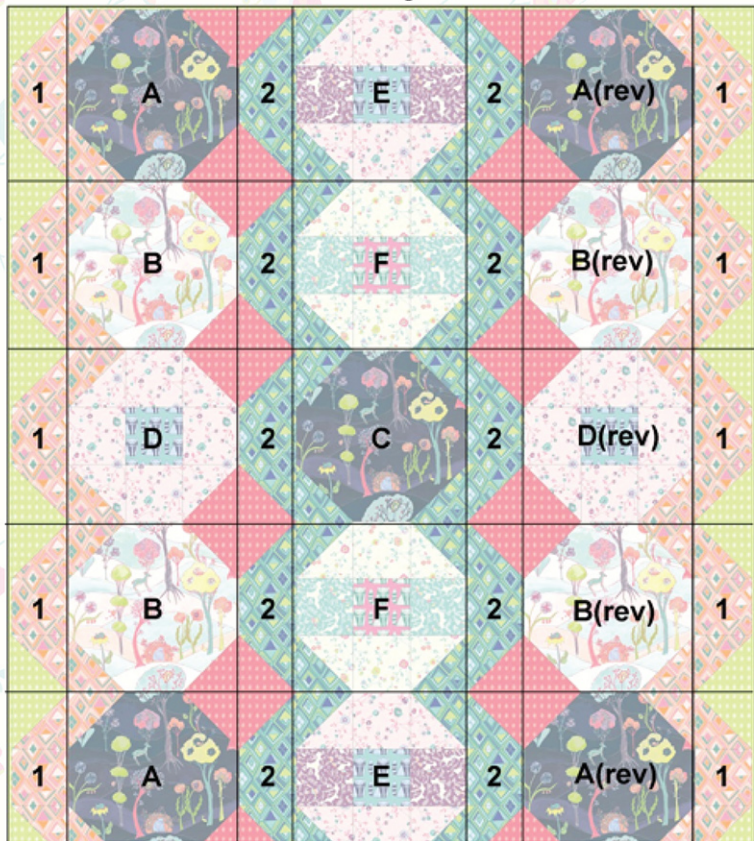

Finishing:

1. Cut the backing into two equal pieces. Remove the selvage along one side of each piece. Sew the two backing pieces together along the edge with the removed selvage, using a 1/2" seam. Press the seam allowance open.
2. Layer the backing right side down, the batting and the quilt top right side up.
3. Quilt as desired.
4. Trim the backing and batting even with quilt top.
5. Cut the binding into 2-1/2" x WOF strips. Sew binding strips together, end to end, on the diagonal. Fold the binding wrong sides together, along the length and press.
6. Apply the binding using your favorite method.

blend
fabrics llc

99 armour dr ne
atlanta, ga 30324
855.817.0604
404.817.0604
www.blendfabrics.com